

# HIGH DEFINITION™ 35 DIRECT VENT GAS FIREPLACE



## Specifications

Model	BTU	Width		Height		Depth		Glass
		Actual	Framing	Actual	Framing	Actual	Framing	
HD35	25,000	35 1/4	35 3/4	41	41 1/4	21 7/8	22 3/8	28 5/32 x 31 1/8

## Front Options

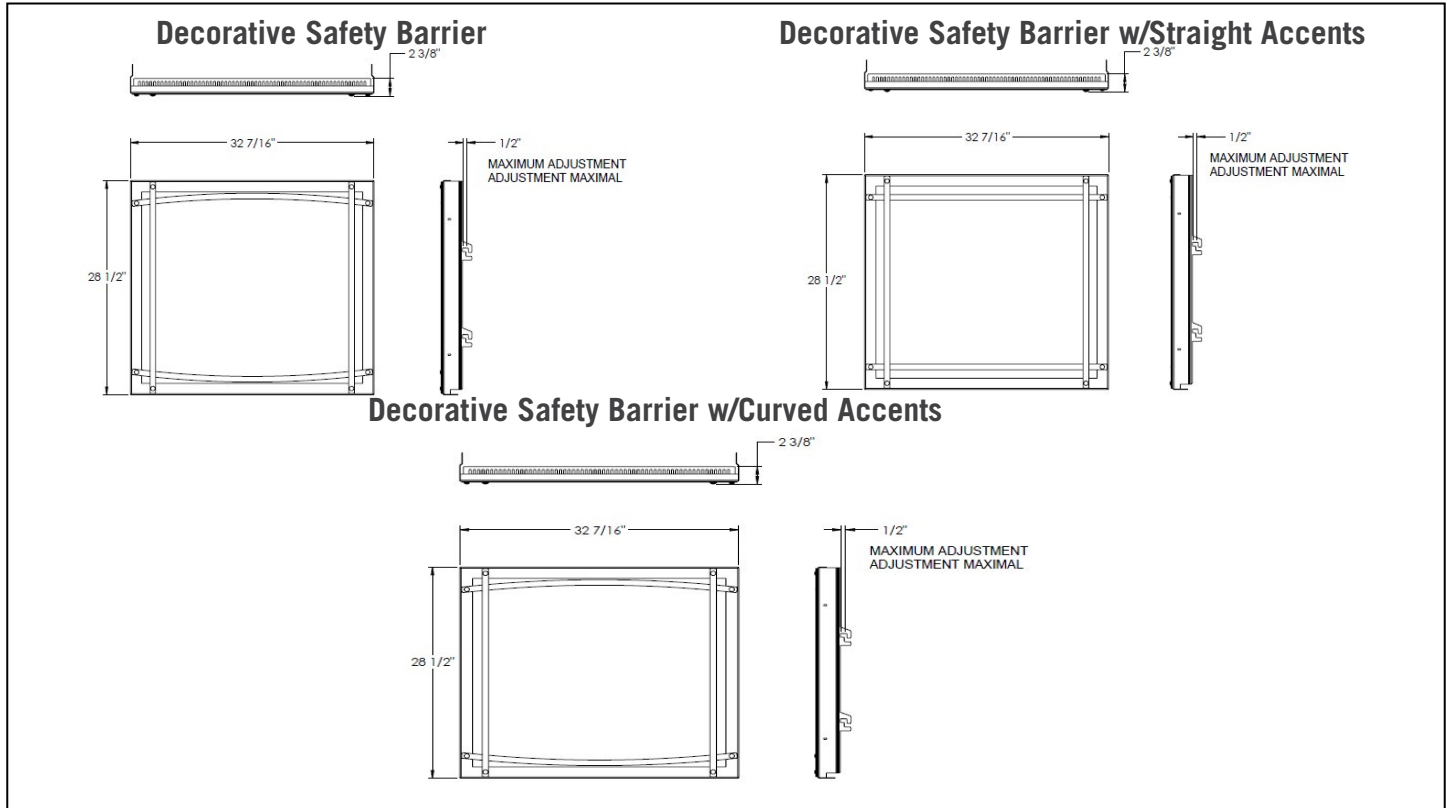

## Minimum Framing Clearances

COMBUSTIBLE FRAMING:	
Sides, back, bottom and top of the appliance	0" to stand offs
COMBUSTIBLE FINISHING:	
Sides, Bottom and Top	1 1/4" (32 mm) to sides, 0" to bottom, 7 3/8" (187 mm) to top of the appliance
Enclosure Top	70" (1778mm) from the bottom of the appliance
Recessed Depth	22 1/4" (565mm)
Sides and bottom of the vent pipe	1** (25mm)
Top of vent pipe	2** (51mm)
Ceiling	62" (1575mm) from the bottom of the appliance

\* **HORIZONTAL VENT SECTIONS:** A minimum clearance of 1" (25mm) at the bottom and sides and 2" (51mm) at the top of the vent pipe in all horizontal runs to combustibles is required except for clearances in appliance enclosures. Horizontal vent sections within enclosures require a minimum clearance of 9" (229mm) at the top of the vent pipe. See "MINIMUM CLEARANCE TO COMBUSTIBLE ENCLOSURES" section. Use firestop spacer W010-1777 (supplied) where vent pipe penetrates combustible walls.

\* **VERTICAL VENT SECTIONS:** A minimum clearance of 1" (25mm) all around the vent pipe on all vertical runs to combustibles is required except for clearances in appliance enclosures. Vertical vent sections within enclosures require a minimum clearance of 4" (102mm) to the sides of the vent pipe. See "MINIMUM CLEARANCE TO COMBUSTIBLE ENCLOSURES" section. Use firestop spacer W500-0367 (not supplied) where vent pipe penetrates combustible ceilings or floors.

## Minimum Framing Clearances

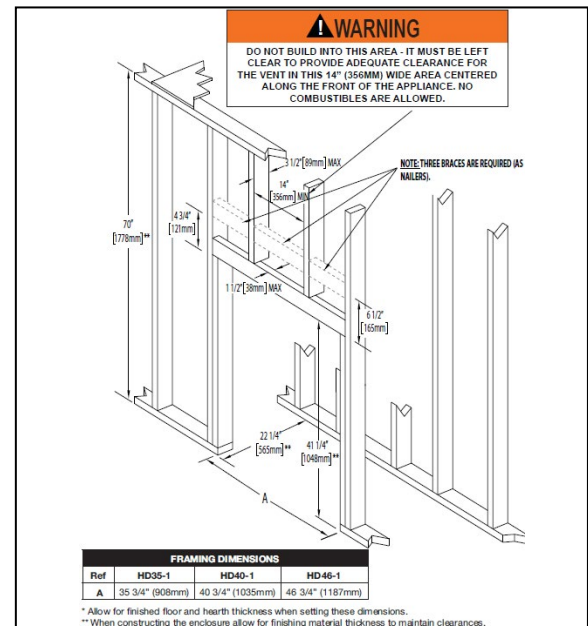

# HIGH DEFINITION™ 35 DIRECT VENT GAS FIREPLACE



Product information provided is not complete and is subject to change without notice. Please consult the installation manual for the most up to date installation information.

## Dimensions

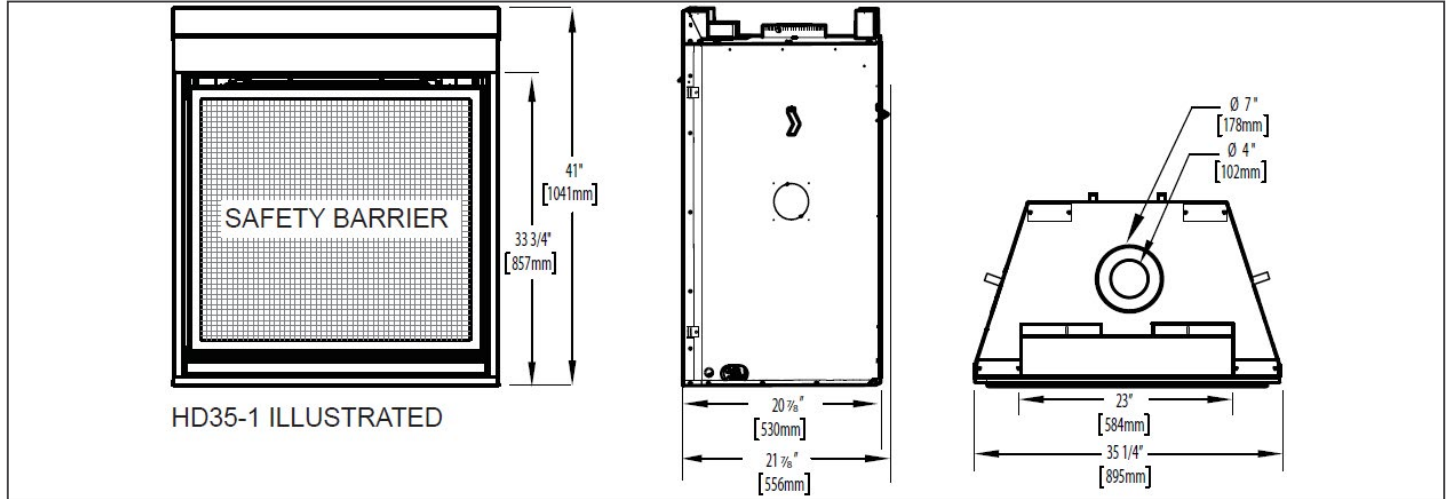

## Wall Penetration

**NOTE:** For detailed installation instructions on the 4-side d frame, optional faceplate or beveled trims refer to the installation instructions provided with the kit.

A joint compound that is resistant to heat and cracking should be used when taping and mudding seams.

NON-COMBUSTIBLE MATERIAL FINISHING DIMENSIONS				COMBUSTIBLE MATERIAL FINISHING DIMENSIONS			
Ref	HD35-1	HD40-1	HD46-1	Ref	HD35-1	HD40-1	HD46-1
A	33" (838mm)	38" (965mm)	44" (1117mm)	A	35 3/4" (908mm)	40 3/4" (1035mm)	46 3/4" (1187mm)
B	33 3/4" (857mm)	33 3/4" (857mm)	33 3/4" (857mm)	B	35 1/2" (902mm)	40 1/4" (1022mm)	46 1/4" (1175mm)
				C	41" (1041mm)	41" (1041mm)	41" (1041mm)

Non-combustible Material Definitions

## Combustible Mantel Clearances

MANTLE DIMENSIONS		
Ref	Height	Depth
A	36" (965mm)	
B	13" (330mm)	2" (51mm)
C	15" (381mm)	4" (102mm)
D	17" (432mm)	6" (152mm)
E	19" (483mm)	8" (203mm)

## Appliance Location

MINIMUM ENCLOSURE CLEARANCES			
Ref	HD35-1	HD40-1	HD46-1
A	35 3/4" (908mm)	40 3/4" (1035mm)	46 3/4" (1187mm)
B	61 1/2" (1562mm)	66 1/2" (1689mm)	72 1/2" (1842mm)
C	43 1/2" (1105mm)	47" (1194mm)	51 1/4" (1302mm)
D	14 13/16" (376mm)	16 9/16" (421mm)	18 11/16" (475mm)
E	32 3/4" (832mm)	35 1/4" (896mm)	38 1/4" (972mm)
F	22 1/4" (565mm)	22 1/4" (565mm)	22 1/4" (565mm)