

GI3600 ACCESSORIES

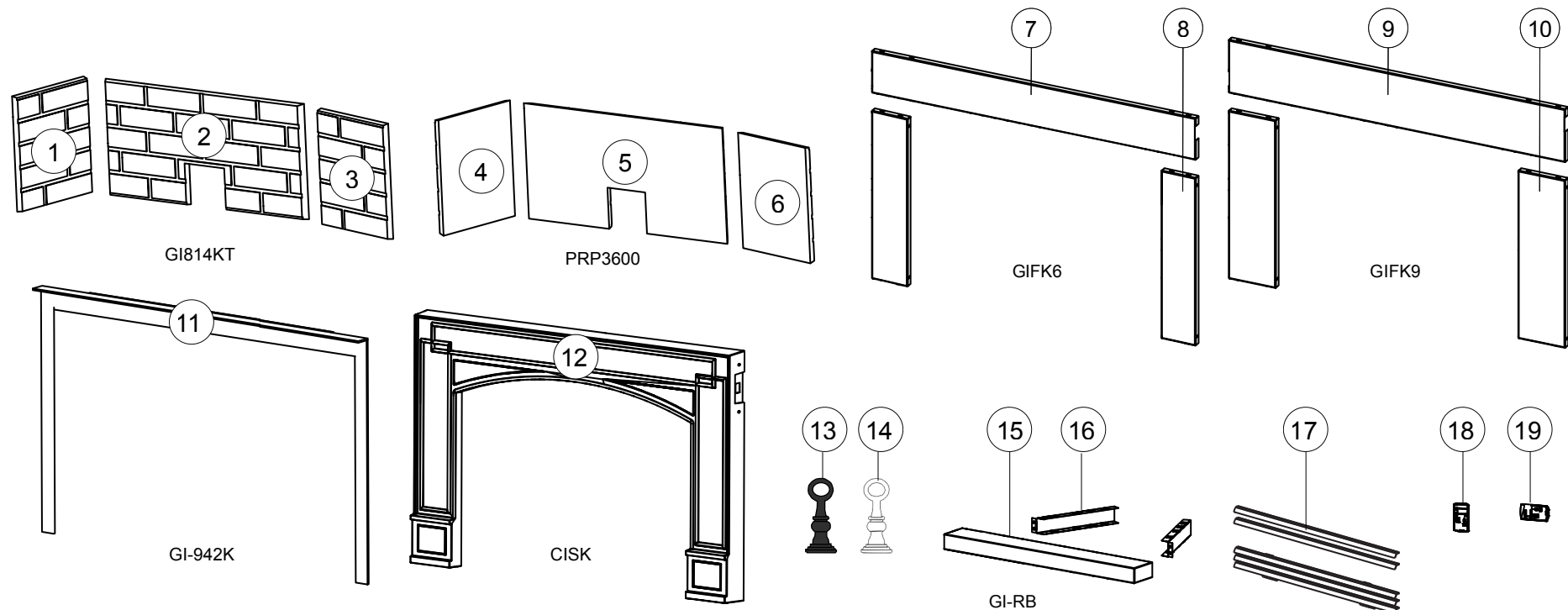

ITEMS MAY NOT APPEAR EXACTLY AS ILLUSTRATED

REF. #	PART #	DESCRIPTION
1	W475-0414	LEFT BRICK PANEL (GI814KT)
2	W475-0413	REAR BRICK (GI814KT)
3	W475-0415	RIGHT BRICK PANEL (GI814KT)
4	W090-0171	LEFT PORCELAIN PANEL (PRP3600)
5	W090-0169	REAR PORELAIN PANEL (PRP3600)
6	W090-0170	RIGHT PORCELAIN PANEL (PRP3600)
7	W263-0182	6" TOP FLASHING (GIF_6)
8	W263-0181	6" SIDE FLASHING (X2) (GIF_6)
9	W263-0184	9" TOP FLASHING (GIFK9)
10	W263-0185	9" SIDE FLASHING (X2) (GIFK9)
11	GI-942K	TRIM (USED WITH BEVELLED FLASHING)

REF. #	PART #	DESCRIPTION
12	CISK	CAST IRON SURROUND
13	ANI-K	BLACK ANDIRONS (X2)
14	ANI-G	GOLD ANDIRONS (X2)
15	W715-0561	HEARTH TRIM (GI-RB)
16	W525-0022	RAILS (X2) (GI-RB)
17	GI-1L	UPPER / LOWER LOUVRES
18	F45 / F60	HAND HELD REMOTE CONTROL
19	W660-0081	WALL MOUNTED THERMOSTAT